

# END PLUGS FOR RAMS WITH TEMPOSONICS® LINEAR POSITION SENSOR

STEEL - S355J0 (FE510C) - S355JR (A105)

SINGLE & DOUBLE ACTING

MAX PRESSURE 250 BAR

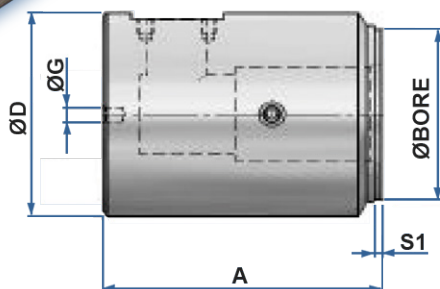
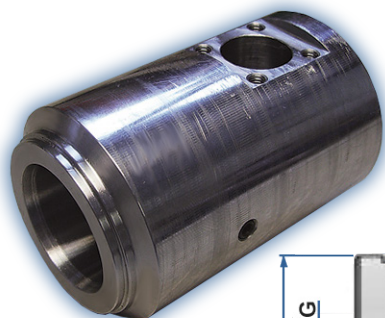

ORDER CODE	BORE Ø(mm)	D Ø(mm)	A (mm)	S1 (mm)	SENSOR TYPE	G Ø(mm)
RPPS40	40	50	75	2	MS	4.25
RPPS50	50	60		10	MH	
RPPS60	60	70				
RPPS63	63	73				
RPPS70	70	80				
RPPS80	80	95				
RPPS90	90	105				
RPPS100	100	115				

**MTS** Temposonics®  
SENSORS

## PISTONS FOR RAMS WITH TEMPOSONICS® LINEAR POSITION SENSOR

STEEL - 9SMN28

SINGLE & DOUBLE ACTING APPLICATION

COMPLETE WITH FULL SEAL KIT

MAX PRESSURE 250 BAR

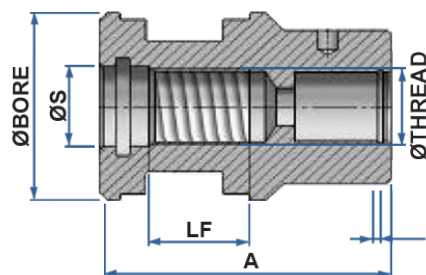

ORDER CODE	BORE Ø(mm)	S Ø(mm)	A (mm)	THREAD (mm)	LF (mm)
RPPS040P	40	20	70	18 x 1.5	24
RPPS050P	50	21	70	20 x 1.5	24

PLEASE NOTE: FOR BORE SIZES Ø60,63,70,80,90 &100, THE 'THREADED PISTONS ARE TO BE USED ALONG WITH THE TEMPOSONICS® SENSOR TYPE 'MH'. THE HOUSING OF THE MAGNET IS LOCATED AND INTEGRATED IN THE ROD STEM.

TEMPOSONICS® SENSOR PISTONS ARE **NOT** SUITABLE FOR USE WITH STANDARD RAMPARTS® RODS.

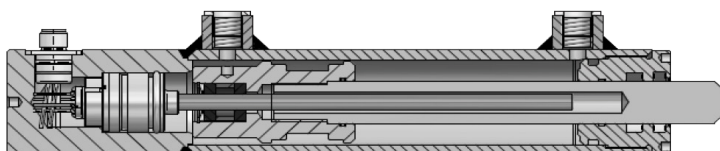

TEMPOSONICS® SENSOR TYPE - MS

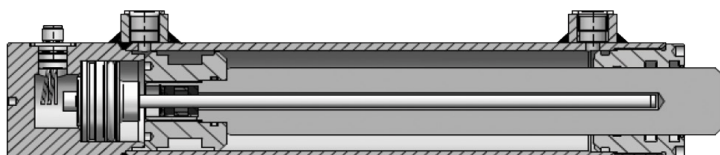

TEMPOSONICS® SENSOR TYPE - MH

## **NEW!** FITTING KITS FOR MTS MS + MH TEMPOSONICS® SENSOR

KIT INCLUDES:

- 1 - CONNECTOR FIXING SCREWS
- 2 - CIRCLIP
- 3 - RING DIN6798A
- 4 - SPACER RINGS

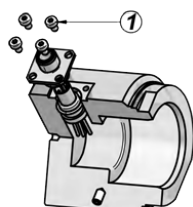
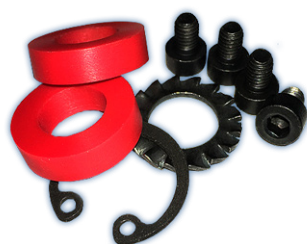

ORDER CODE	DESCRIPTION
CKMSMH0100	FITTING KIT FOR "MS/MH" SENSOR

PLEASE NOTE: SENSOR AND MAGNET NOT INCLUDED

