

# FLANGES (4 & 6 BOLT)

STEEL - S355J0 (FE510C)

ORDER CODE	C Ø(mm)	D Ø(mm)	F Ø(mm)	A (mm)	PCD Ø(mm)
RPCFL0035	35	72	7 (x4)	10	60
RPCFL0040	40	80	9 (x4)	12	65
RPCFL0042	42	89	9 (x4)	12	70
RPCFL0045	45	95	9 (x4)	12	75
RPCFL0050	50	109	11 (x4)	12.5	87
RPCFL0055	55	123	11 (x4)	14.5	100
RPCFL0060	60	128	13 (x4)	14.5	105
RPCFL0065	65	135	13 (x4)	15.5	110
RPCFL0070	70	142	13 (x4)	16.5	117
RPCFL0073	73	145	13 (x4)	16.5	120
RPCFL0075	75	152	13 (x4)	16.5	125
RPCFL0080	80	162	15 (x4)	16.5	127
RPCFL0090	90	175	15 (x4)	18.5	145
<b>NEW!</b> RPCFL0092	92	181	17 (x6)	18.5	149
RPCFL0095	95	181	17 (x6)	18.5	149
RPCFL0100	100	190	17 (x6)	18.5	155
RPCFL0105	105	190	17 (x6)	24.5	156
RPCFL0115	115	194	17 (x6)	24.5	162
RPCFL0123	123	230	21 (x6)	28	190
RPCFL0138	138	240	21 (x6)	28	200
RPCFL0143	143	250	21 (x6)	28	210
RPCFL0158	158	280	23 (x6)	33	230
RPCFL0168	168	300	25 (x6)	38	250
RPCFL0178	178	325	28 (x6)	38	270

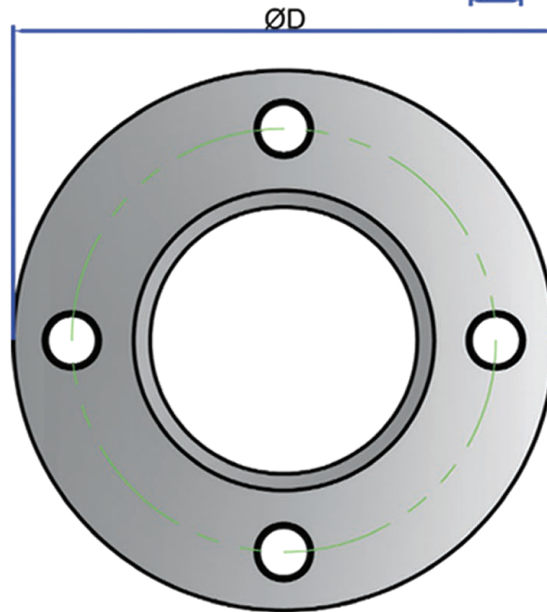
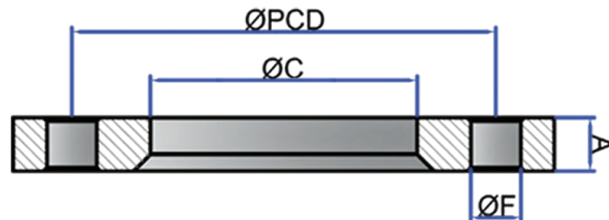

TYPE 2					
RP4512	45	95	8.5 (x6)	12	75
RP5012	50	100	8.5 (x6)	12	80
RP5512	55	105	8.5 (x6)	12	85
RP6015	60	120	11 (x6)	15	95
RP6515	65	125	11 (x6)	15	100
RP7015	70	130	11 (x6)	15	105
RP7315	73	135	13 (x6)	15	110
RP7515	75	135	13 (x6)	15	110
RP8015	80	135	13 (x6)	15	110
RP8020	80	150	13 (x6)	20	120
RP8520	85	150	13 (x6)	20	120
RP9020	90	170	15 (x6)	20	135
RP9520	95	170	15 (x6)	20	135
RP10025	100	180	15 (x6)	25	145
RP10525	105	180	15 (x6)	25	145
RP11525	115	195	17 (x6)	25	160
RP12025	120	195	17 (x6)	25	160
RP12528	125	215	19 (x6)	28	175
RP13028	130	215	19 (x6)	28	175
RP13033	135	230	19 (x6)	33	190
RP14033	140	230	19 (x6)	33	190
RP14533	145	240	19 (x6)	33	195
RP14533A	145	250	21 (x6)	33	205
RP15033	150	250	21 (x6)	33	205
RP16035	160	270	23 (x6)	35	220
RP17038	170	280	23 (x6)	38	230
RP18040	180	310	25 (x6)	40	250
RP18540	185	320	25 (x6)	40	260

IT IS RECOMMENDED THAT THE TUBE BORE IS THREADED / RE-THREADED AFTER FLANGE FITMENT TO THE OUTSIDE OF TUBE ON FRONT FLANGE ASSEMBLIES. THIS IS DUE TO POTENTIAL TUBE DISTORTION AFTER WELDING.